

# 2019 FOUR

You are very welcome to join us for the next Learning Environments Australasia NSW Chapter Event ...

## Newcastle / Hunter Valley Site Visits

*Inclusive of three sites across three educational services: Primary, Secondary and Tertiary. Each unique, addressing contemporary learning philosophies while valuing the physical environment and the history and culture each site.*

**NeW Space - University of Newcastle  
Hunter Valley Grammar School  
St Patricks Primary School**

Date: **Friday 2 August, 2019**  
Time: **10.00 am - 4.00 pm**



St Patricks Primary School



University of Newcastle

Photographer Credit: Peter Bennetts

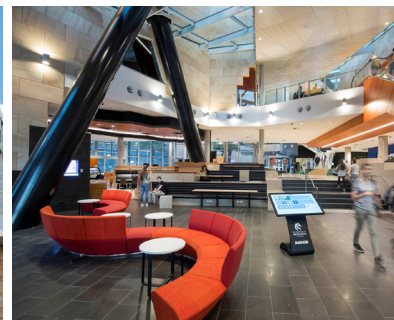

Hunter Valley Grammar School

Photographer Credit: Christopher Burgess

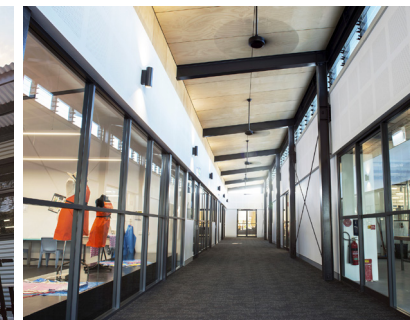

To align with the 3R's of the LEA 2018 Conference, the NSW Chapter seeks to provide opportunities to learn from the threads of reflection, relevance and revolution in real situations.

## The LEA NSW Chapter warmly invites you to Newcastle / Hunter Valley ...

**10.00 am - The day will begin at NeW Space:** The NeW Space project is a new vertical campus for the University of Newcastle within the city's civic precinct. EJE Architecture has designed this site in collaboration with Melbourne based firm Lyons Architects. The \$95million project will accommodate both formal and informal teaching and learning space for approximately 3500 students as well as 400 staff.

### 11.30 am - Travel to Hunter Valley Grammar School (Maitland)

#### 12.00 pm - Tour of the school

Mayoh Architects were engaged to design a new TAS building. The new building includes woodwork and metalwork workshops, a digital fabrication laboratory, a textiles workshop, teaching kitchens, display areas, and staff and storage facilities. This facility is Stage 1 of the master plan. Mayoh will present to you, the next stage.

### 1.00 pm - Lunch at Maitland Regional Art Gallery (MRAG)

#### 2.30 pm - St Patricks Primary School (Lochinvar)

St Patrick's Primary School is an exemplary master planning and architectural solution to the needs of a growing school community with a legacy of outdated and unsuitable school buildings. The **award winning design**, by **SHAC Architects**, accomplishes much with little.

## Event Details

[www.a4le.org.au](http://www.a4le.org.au)

- ❑ **NeW Space - University of Newcastle**  
Cnr Hunter and Auckland St, Newcastle NSW
- ❑ **Hunter Valley Grammar School**  
42 Norfolk St, Ashtonfield NSW
- ❑ **St Patricks Primary School**  
65 New England Hwy, Lochinvar

**Transportation** - Attendees are encouraged to make their own way to each venue. Car sharing can be arranged if needed. Please email [nsw@a4le.org.au](mailto:nsw@a4le.org.au)

- ❑ **Friday 2 August, 2019**  
10.00 am - 4.00 pm
- ❑ **Cost: Members \$45 and Non-Members \$90.**  
Please book as soon as possible to secure your place.
- ❑ **[www.a4le.org.au/events](http://www.a4le.org.au/events)** for registration and event details.